

# ENGINE WIRE HARNESS & BRACKET, Gi

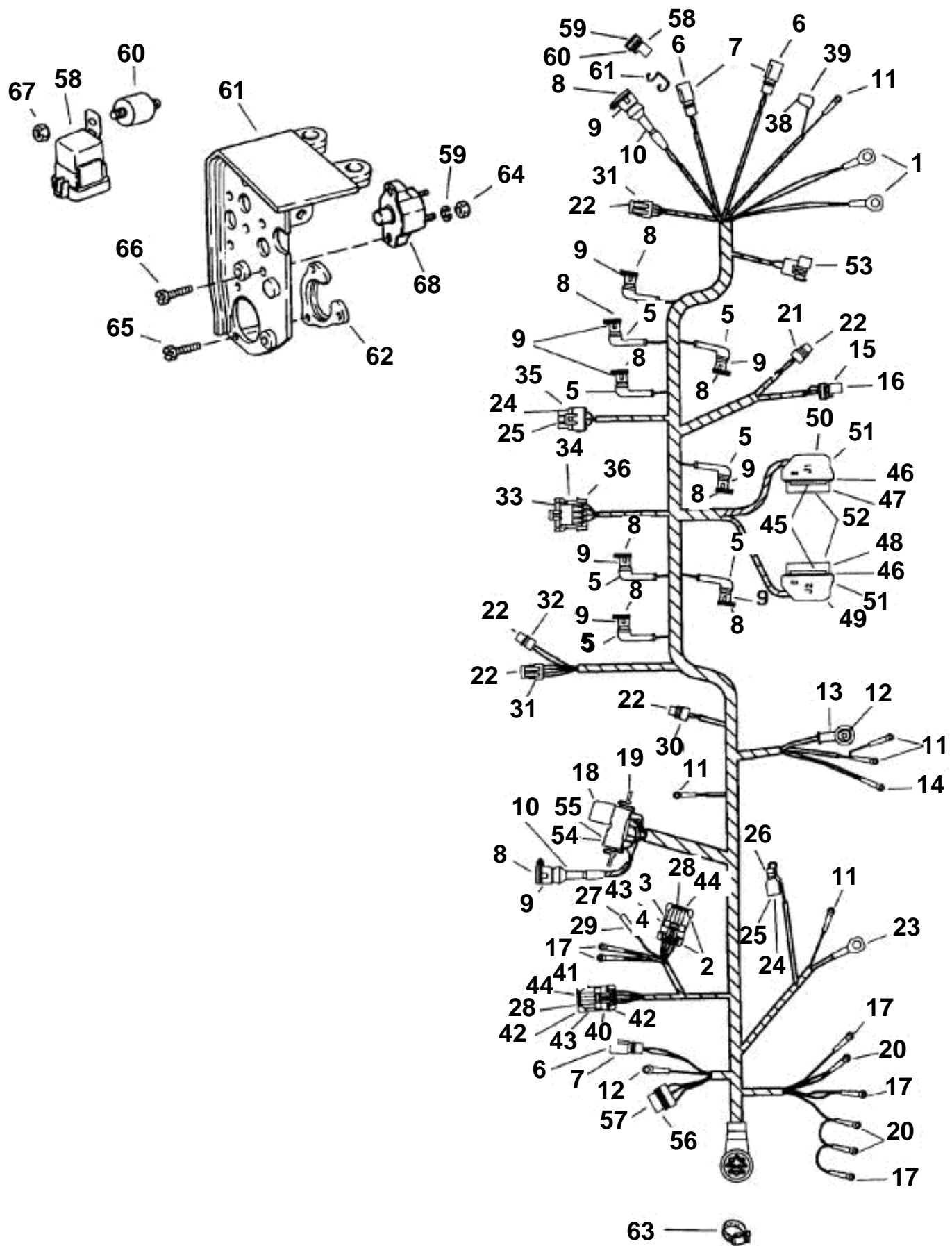

# ENGINE WIRE HARNESS & BRACKET, Gi

REF	PART NO.	QTY	DESCRIPTION
	3854576	1	Cable harness, Engine
1	3852527	2	· Cable terminal
2	3855263	2	· Cap, 4-pin connector
3	3855240	1	· Connector, 4-pin
4	3855239	1	· Connector, 4-pin
5	3853711	8	· Cable sleeve, Injector
6	3852229	6	· Cable terminal, Pin
7	3853565	3	· Connector, 2-pin
8	3853679	20	· Cable terminal
9	3855021	10	· Housing
10	3853681	2	· Cover, Fuel pump
11	3852233	5	· Cable terminal
12	3852107	2	· Cable terminal
13	3852130	1	· Rubber cap, Alternator
14	3852036	1	· Cable terminal, Alt. ground
15	3855077	1	· Connector, Shift assist
16	3852257	6	· Cable terminal, Shift assist
17	3852235	5	· Cable terminal
18	3850403	2	· Relay, Fuel pump
19	3852210	1	· Bracket, Relay
20	3854245	3	· Cable terminal
21		1	· MAT sensor
22	3855242	15	· Cable terminal
23	3855022	1	· Cable terminal, Starter
24	3855023	4	· Cable terminal, Sensor
25	3853478	8	· Seal, Terminal
26	3853480	1	· Terminal casing, Knock sensor
27	3855024	1	· Cable terminal, Ignition cutoff
28	3855243	9	· Seal, Connector
29	3855025	1	· Cable sleeve, Terminal
30	3855244	1	· Connector, Temp. switch
31	3855027	2	· Cable terminal, 4-terminal
32	3855245	1	· Connector, 3-terminal
33	3855246	1	· Cable terminal, Spark control
34	3855247	1	· Connector, Spark control
35	3855248	1	· Connector, MAP sensor
36	3855249	1	· Connector, 5-pin connector
37	3852527	2	· Cable terminal, Ground
38	3852084	1	· Cable terminal, Oil switch
39	3852320	1	· O-ring, Terminal, Oil switch
40	3855251		· Connector
41	3855252	1	· Connector
42	3855253	2	· Cap, Connector
43	3855267	9	· Cable terminal
44	3855254	19	· Plug
45	3855255	2	· Connector, Connector
46	3855256	2	· Seal
47	3855257	1	· Connector, Connector, J1 module
48	3855258	1	· Connector, Connector, J2 module
49	3855259	1	· Connector housing, J2 module
50	3855260	1	· Connector housing, J1 module
51	3855261	28	· Plug
52	3855262	36	· Cable terminal
53	3854244	1	· Cable, Ignition coil
54	3852246	5	· Cable terminal, Relay
55	3852247	3	· Cable terminal, Relay
56	3854192		· Connector, Starter solenoid
57	3852254	4	· Cable terminal, Starter solenoid
58	3855178	1	· Connector, Slave
59	3852230	2	· Plug
60	3853564		· Connector
61	3852237	1	Retainer, Connector
62	3850455		Bracket, Engine cable
63	3853786		Clamp, Engine cable end

7797019 - - 0-0013

GR9991013

Upd: 15 FEB 2006

HU, 7.4 GL, 8.2 GL; 7.4 Gi; 7.4 Gsi

**VOLVO**  
**PENTA**

# ENGINE WIRE HARNESS & BRACKET, Gi

REF	PART NO.	QTY	DESCRIPTION
64	3852064	8	Nut, Circuit breaker
65	3852208	3	Screw, Cable retainer to bracket
66	3853620	6	Screw, Circuit breaker to bracket
67	3852118		Nut, Relay to isolator
68	3854138		Relay, Starter
69	3854162	1	Breaker, 125A, ignition
	3854186		Fuse, 60A, engine
70	3854117		Cable, Starter solenoid to fuel pump
71	3855178	1	Connector
72	3855162		CONNECTOR, PLUG, & JUMP
			CONNECTOR, MAT sensor
73	3854521		Control unit, Knock
74	3852001	8	Lock washer, Circuit breaker
75	3852825		Retainer, Engine cable
76	3850234		Isolation, Relay